

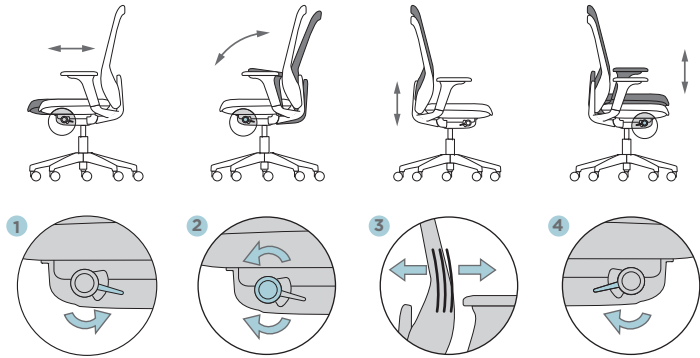

# AURA WORK CHAIR



## FEATURES



2 types of backrest, black (NE) or white (BA) (optional)



# TECHNICAL SHEETS



## OPTIONS

### Armrests

- Height adjustment: 100 mm, 9 positions
- Depth adjustment: 55 mm
- Rotation adjustment: 20° (-10°, 0°, +10°)
- Depth adjustment: 25 mm

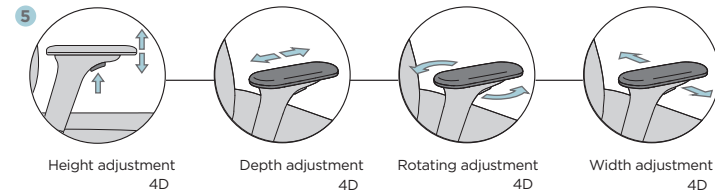

## DIMENSIONS

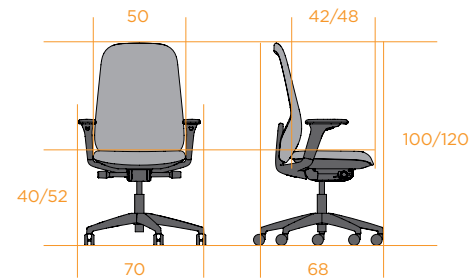

kg	Weight in kg	17,10
Ta	Seat fabric	0,64 ml (2 units)



# AURA WORK CHAIR

# TECHNICAL SHEETS



## DESCRIPTION

### BACKREST

Height adjustment: 90mm, lockable in 20 positions. Maximum opening 21°.

Lockable in 5 positions or permanent contact with non-return system.

Lumbar support consisting of a polyamide injection part, adjustable in depth by 20 mm, lockable in 3 positions.

**Mesh backrest:** Polyamide perimeter frame with rectangular-shaped props, onto which the black (NE) mesh is fitted. Its tautness means that the backrest supports the user's back properly. Does not deform.

### SEAT

Depth adjustment: 70 mm with 8 positions.

Ergonomically shaped, fibre-reinforced, injection-moulded polypropylene support with flexible rubber foam with a thickness of 45 mm and a density of 40kg/m<sup>3</sup>, onto which the fabric is fitted.

### MECHANISM

Spring-loaded, self-weighting synchro mechanism (self-adjusts the pressure of the backrest to the weight of the user).

4 positions to customise tension. Black finish.

### BASE

Fibre-reinforced base: Ø 680mm. Finish: Black.

Aluminium base: Ø 700mm. Finish: Polished or coated with polyester epoxy.

Castors for hard or soft floor: Ø 60mm, black finish.

Conductive castor option: Ø 60mm.



### ARMRESTS



▲ 4D armrests



## RECYCLABILITY RATE



## CERTIFICATIONS



UNE EN 1335